

# Notice of ground investigation works



January 2019 | [www.hs2.org.uk](http://www.hs2.org.uk)

High Speed Two (HS2) is the new high speed railway for Britain which will provide a vital transport link for the country. Initial works on Phase One of HS2, from London to the West Midlands, have now started. These early works are carried out by LM – a joint venture between Laing O’Rourke and J. Murphy & Sons.

We will be in your area to carry out ground investigation works. These surveys will allow us to identify utilities located along a short section of the **A429 Kenilworth Road**. These surveys will be carried from **Wednesday 6<sup>th</sup> February and are expected to take up to 1 week**, subject to permits and site conditions.

Controlled temporary traffic restrictions using portable traffic signals will be in place on each day from 9.30am, with restrictions lifted and the road fully re-opened by 3.30pm.

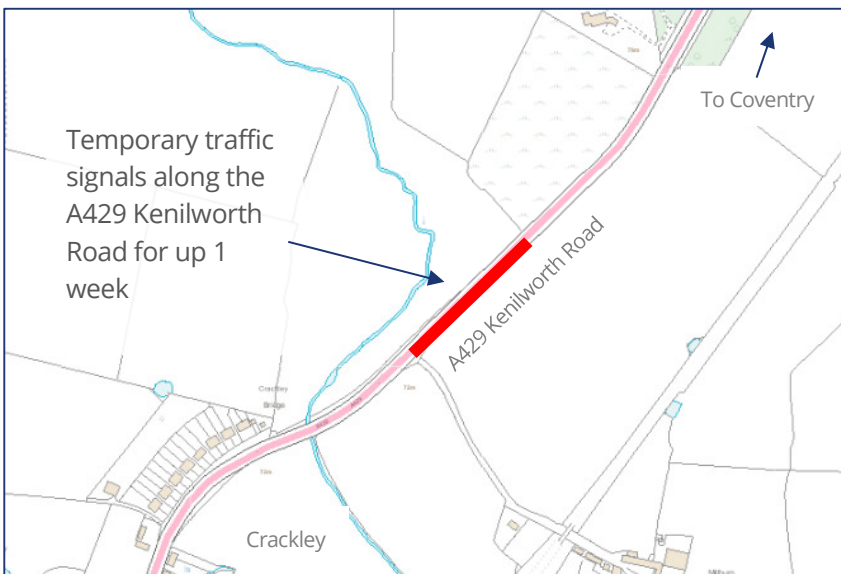

Contains Ordnance Survey data ©Crown copyright and database right 2017

**If you have a question about HS2 or our works, please contact our helpdesk on 08081 434 434 or email [HS2enquiries@hs2.org.uk](mailto:HS2enquiries@hs2.org.uk)**

## Duration of works

From 6<sup>th</sup> February for up 1 week.

Daytime working hours from 9.30am to 3.30pm.

Our contractors may also be on site for up to one hour beforehand to set up the works.

## What to expect

Some noise from on-site machinery during working hours.

Some disruption to traffic. Portable traffic lights will be in use.

Access for pedestrians and cyclists will be maintained.

## What we will do

Inform you in advance of any changes.

Keep all sites safe and secure.



Working on  
behalf of



# Keeping you informed

We are committed to keeping you informed about work on HS2. This includes ensuring you know what to expect and when to expect it, as well as how we can help.

## Residents' Charter and Commissioner

The Residents' Charter is our promise to communicate as clearly as we possibly can with people who live along or near the HS2 route. [www.gov.uk/government/publications/hs2-residents-charter](http://www.gov.uk/government/publications/hs2-residents-charter)

We also have an independent Residents' Commissioner whose job is to make sure we keep to the promises we make in the Charter and to keep it under constant review. Find reports at: [www.gov.uk/government/collections/hs2-ltd-residents-commissioner](http://www.gov.uk/government/collections/hs2-ltd-residents-commissioner)

You can contact the Commissioner at: [residentscommissioner@hs2.org.uk](mailto:residentscommissioner@hs2.org.uk)

## Construction Commissioner

The Construction Commissioner's role is to mediate and monitor the way in which HS2 Ltd manages and responds to construction complaints. You can contact the Construction Commissioner by emailing [complaints@hs2-cc.org.uk](mailto:complaints@hs2-cc.org.uk).

## Property and compensation

You can find out all about HS2 and properties along the line of route by visiting:

[www.gov.uk/government/collections/hs2-property](http://www.gov.uk/government/collections/hs2-property)

Find out if you're eligible for compensation at:

[www.gov.uk/claim-compensation-if-affected-by-hs2](http://www.gov.uk/claim-compensation-if-affected-by-hs2)

## Contact us

If you have any questions about this newsletter, please get in touch.

 **24/7 freephone** 08081 434 434

 **Minicom** 08081 456 472

 **Email** [HS2enquiries@hs2.org.uk](mailto:HS2enquiries@hs2.org.uk)

### High Speed Two (HS2) Limited

Two Snowhill

Snow Hill Queensway

Birmingham B4 6GA

**Website** [www.hs2.org.uk](http://www.hs2.org.uk)

**To keep up to date with what is happening in your area, visit:**

**[hs2inwarwicks.commonplace.is](http://hs2inwarwicks.commonplace.is)**

**Please contact us if you'd like a free copy of this document in large print, Braille, audio or easy read. You can also contact us for help and information in a different language.**

HS2 Ltd is committed to protecting personal information. If you wish to know more about how we use your personal information please see our Privacy Notice (<https://www.gov.uk/government/publications/high-speed-two-ltd-privacy-notice>).

Reference number: 1EW04-LMJ-CO-NTE-NS01\_NL03-106002

# HS2