

From: Reuben Bellamy **Sent:** 14 November 2016 15:54 **To:** Lorna Coldicott; Dave Barber **Subject:** Local Plan Examination : Burton Green H24 - noise

Dear Lorna and Dave,

Further to my email earlier today, please find attached a map and noise readings regarding the impact of Hs2. The plan clearly shows that the impact on the H24 site is negligible. As can be seen below H2S are happy for this plan to be made public. This is hard evidence that puts to bed Turley's suggestion that the site might not be delivered in the plan period due to noise.

I hope you are able to use this information to support the allocation of the site.

Regards

Reuben

Reuben Bellamy BA(Hons) MA MRTPI
Planning Director

From: Daniel Forrester **Sent:** 14 November 2016 14:38 **To:** Reuben Bellamy **Subject:** FW: Burton Green

Reub,
Pls submit this plan for noise.

thanks

Dan Forrester BSc (Hons)
MSc
Land Manager
**CALA Homes Midlands
Ltd**

From: Jonathan Lord **Sent:** 14 November 2016 14:36 **To:** Daniel Forrester; Rachna Shah1 **Subject:** RE: Burton Green

Dear Daniel

On the basis that the information has previously been made available in the public domain I have no objections for you publishing the attached plan. Please could you ensure that they are published as provided.

Kind regards
Jonathan

From: Daniel Forrester **Sent:** 14 November 2016 09:24 **To:** Rachna Shah1 **Cc:** Jonathan Lord **Subject:** RE: Burton Green

Morning Rachna,

Hope you are well.

Further to our emails last week we would also (subject to your agreement) like to submit the attached plan to the EIP inspector to show that our site is not materially affected by the noise impact of the line.

This plan was provided to CALA by HS2 under an NDA and thus we would need your written approval to submit the plan. The EIP is tomorrow so a response today would be very much appreciated.

Kind regards

Dan Forrester BSc (Hons)
MSc
Land Manager
**CALA Homes Midlands
Ltd**

From: Rachna Shah1 **Sent:** 11 November 2016 10:08 **To:** Daniel Forrester **Cc:** Jonathan Lord **Subject:** RE: Burton Green

I can confirm that this is ok.

Yours,

Rachna Shah | Engagement Executive | HS2 Ltd



From: Daniel Forrester **Sent:** 11 November 2016 09:32 **To:** Rachna Shah1 **Subject:** FW: Burton Green

Rachna,

I just intend to send in your email below and the plan you attached. Please confirm this is ok?

thanks

Dan Forrester BSc (Hons)
MSc
Land Manager
**CALA Homes Midlands
Ltd**

From: Rachna Shah1 **Sent:** 11 November 2016 09:07 **To:** Jonathan Lord; Daniel Forrester **Cc:** Reuben Bellamy **Subject:** RE: Burton Green

Dear Daniel,

Thank you for your emails.

I have confirmed with my construction colleagues and I can confirm

that the details in the original plan I sent you (attached) are still correct, in that our compound is not on your land – of Burrow Hill Nurseries (within the red box).

It would be useful if you could send us your plans and we will do a secondary check.

Please do contact me if you have any questions.

Yours,

Rachna Shah | Engagement Executive | HS2 Ltd



From: Jonathan Lord **Sent:** 10 November 2016 17:18 **To:** Daniel Forrester **Cc:** Rachna Shah1; Reuben Bellamy **Subject:** RE: Burton Green

Dear Daniel

I have asked my colleague to respond tomorrow; she is confirming with the construction team.

Kind regards
Jonathan

From: Daniel Forrester **Sent:** 09 November 2016 16:52 **To:** Jonathan Lord **Cc:** Rachna Shah1 Reuben Bellamy **Subject:** RE: Burton Green

Jonathan,

Sorry to chase but I have not yet had a response from you on my email below. Could you please confirm?

Kind regards

Dan Forrester BSc (Hons)
MSc
Land Manager
**CALA Homes Midlands
Ltd**

From: Daniel Forrester **Sent:** 03 November 2016 14:09 **To:** 'Jonathan Lord' **Cc:** Rachna Shah1; Reuben Bellamy **Subject:** RE: Burton Green

Jonathan,

Hope you are well.

Hoping you can help. Through the examination of the local plan a competing developer has submitted representations stating that they understand that HS2 intend to place a compound on our site in Burton Green (Burrow Hill nurseries).

As you will recall you have previously (Verbally) confirmed to me that this is not the case. Further the plan (attached) you provided to me previously also shows this not to be the case.

We would like to clarify this to the EIP inspector and thus an email/ letter from you would be incredibly helpful.

I look forward to hearing from you.

Kind regards

Dan Forrester BSc (Hons)
MSc
Land Manager
**CALA Homes Midlands
Ltd**

From: Jonathan Lord **Sent:** 01 September 2016 17:03 **To:** Daniel Forrester **Cc:** Rachna Shah1 **Subject:** RE: Burton Green

Hi Dan

My colleague (Rachna Shah) is in the process of collating the information and will provide an update next week.

Kind regards
Jonathan

From: Daniel Forrester **Sent:** 22 August 2016 11:19 **To:** Jonathan Lord
Subject: RE: Burton Green

Jonathan,

Are you now able to provide the documents?

thanks

Dan Forrester BSc (Hons)
MSc
Land Manager
**CALA Homes Midlands
Ltd**

From: Daniel Forrester **Sent:** 10 August 2016 14:10 **To:** 'Jonathan Lord' **Subject:** RE: Burton Green

Jonathan.

Thanks they are in the post to andy.

regards

Dan Forrester BSc (Hons)

MSc
Land Manager
**CALA Homes Midlands
Ltd**

From: Jonathan Lord **Sent:** 10 August 2016 12:03 **To:** Daniel Forrester; Reuben Bellamy **Cc:** Mark Gay **Subject:** RE: Burton Green

Dear Dan

Many thanks for emailing me a copy of the signed NDA. Please could you post two signed versions to:

FAO Andy Taylor, Corporate Affairs
HS2 Ltd

You will then receive by return post a signed copy for your records.

In the meantime I am finalising the collation of the information requested to forward.

Kind regards
Jonathan

From: Daniel Forrester **Sent:** 09 August 2016 16:38 **To:** Jonathan Lord Reuben Bellamy **Cc:** Mark Gay **Subject:** RE: Burton Green

Jonathan,

Firstly apologies for the delayed response- I was off on annual leave.

Please find attached however a signed copy of the NDA.

I would be grateful if you could please on this basis send through the information requested.

Kind regards

Dan Forrester BSc (Hons)
MSc
Land Manager
**CALA Homes Midlands
Ltd**

From: Jonathan Lord **Sent:** 19 July 2016 12:26 **To:** Daniel Forrester;
Reuben Bellamy **Cc:** Mark Gay **Subject:** RE: Burton Green

Dear Daniel

Further to your recent email exchange with my colleague, Donovan Bailey please find attached a non-disclosure agreement for your comments. Once this is signed I will be able to collate and send all of the information requested.

I will send the first two pieces of information requested shortly.

Kind regards
Jonathan

Jonathan Lord | Senior Area Engagement Manager – Area North |
Corporate Affairs | HS2 Ltd

From: Donovan Bailey **Sent:** 15 July 2016 14:22 **To:** Daniel Forrester <
Reuben Bellamy < Jonathan Lord < > **Cc:** Mark Gay > **Subject:** RE:
Burton Green

Hi Daniel,

I've included a colleague - Jonathan Lord - who is the Senior Engagement Manager for this area. Jonathan has kindly agreed to pick this up as it sits within his remit.

Jon – over to you.

Regards
Donovan

Donovan Bailey | Senior Interface Manager – Construction Area
North
AND Senior Commercial Manager – Hybrid Bill Delivery

From: Daniel Forrester **Sent:** 14 July 2016 09:22 **To:** Donovan Bailey
Reuben Bellamy **Cc:** Mark Gay **Subject:** Burton Green

Morning Donovan,

Firstly- thank you for meeting with me yesterday to discuss the HS2 line in Burton Green.

As discussed we agreed that you would send to us the following information/ plans- I would be very grateful if you could please.

- . Traffic (construction) movements plan
- . Sound impact plans
- . HS2 compound location and activity plan
- . Foul pipeline relocation plan
- . Haulage road plan (to serve compound)
- . Programme for HS2 works in Burton Green- we agreed that this is to be accompanied by a NDA- HS2 to provide a draft.

I am off from today but my colleagues (cc'd in) will run this job in my absence. Thus I would be grateful if you could send the information to them too.

Kind regards

Dan Forrester BSc (Hons)
MSc
Land Manager
**CALA Homes Midlands
Ltd**

Comparison main ES/AP₄ noise levels – Burton Green

Assessment location ID	Number of dwellings	Noise levels Proposed Scheme only (day): ES (dB)	Noise levels Proposed Scheme only (day): AP ₄ (dB)	Reduction in HS2 noise level	Noise change: ES design		Noise change: AP ₄ design	
					Day	Night	Day	Night
204193	4	43	43	0	1	1	1	1
204223	4	44	44	0	2	1	2	1
204255	6	48	43	-5	3	2	1	1
204647	10	51	44	-7	5	3	2	1
204672	10	44	45	+1	2	1	2	1
204916	4	49	48	-1	4	1	3	1
204998	5	46	39	-7	2	0	0	0
205051	6	47	43	-4	2	0	1	0
205176	10	43	43	0	1	1	2	1
205246	10	44	43	-1	1	1	1	0
205259	1	53	42	-11	5	2	1	0
206392	13	55	54	-1	2	3	2	2
206515	1	51	48	-3	2	3	1	2
206515	5	53	53	0	2	2	2	2

Key for noise change columns

Negligible Impact

Minor Impact

Moderate Impact

Major Impact

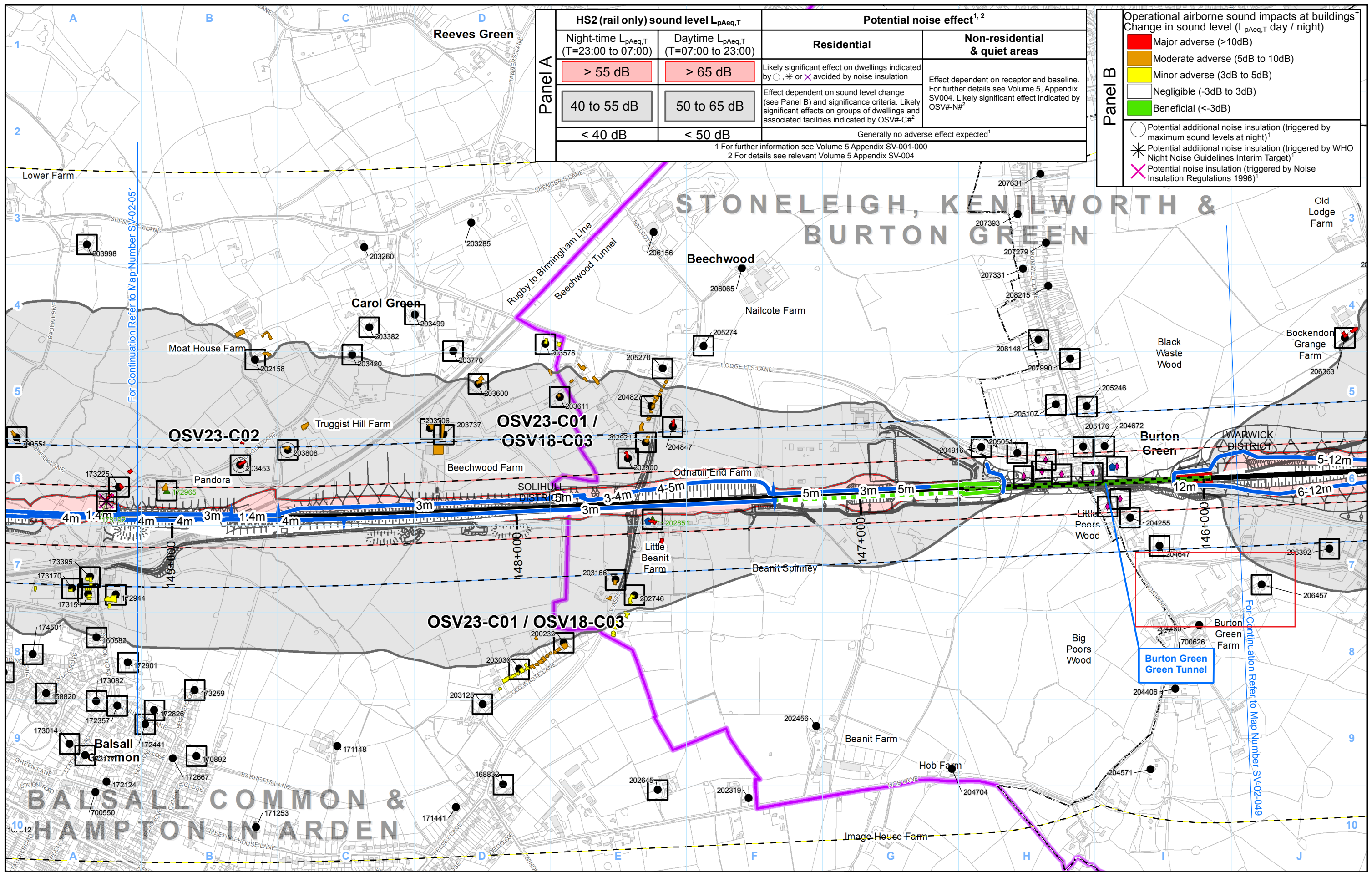

Panel A	HS2 (rail only) sound level $L_{pAeq,T}$		Potential noise effect ^{1, 2}	
	Night-time $L_{pAeq,T}$ (T=23:00 to 07:00)	Daytime $L_{pAeq,T}$ (T=07:00 to 23:00)	Residential	Non-residential & quiet areas
	> 55 dB	> 65 dB	Likely significant effect on dwellings indicated by ○, * or ✕ avoided by noise insulation	Effect dependent on receptor and baseline. For further details see Volume 5, Appendix SV004. Likely significant effect indicated by OSV#-N# ²
	40 to 55 dB	50 to 65 dB	Effect dependent on sound level change (see Panel B) and significance criteria. Likely significant effects on groups of dwellings and associated facilities indicated by OSV#-C# ²	
	< 40 dB	< 50 dB	Generally no adverse effect expected ¹	
	1 For further information see Volume 5 Appendix SV-001-000 2 For details see relevant Volume 5 Appendix SV-004			

Panel B	Operational airborne sound impacts at buildings ¹ Change in sound level ($L_{pAeq,T}$ day / night)	
	Major adverse (>10dB)	
	Moderate adverse (5dB to 10dB)	
	Minor adverse (3dB to 5dB)	
	Negligible (-3dB to 3dB)	
	Beneficial (<-3dB)	
○ Potential additional noise insulation (triggered by maximum sound levels at night) ¹		
✱ Potential additional noise insulation (triggered by WHO Night Noise Guidelines Interim Target)		
✕ Potential noise insulation (triggered by Noise Insulation Regulations 1996) ¹		

Legend - General features

- Route in bored tunnel
- Route in green tunnel
- Route on surface
- Depot, station, headhouse or portal building
- Community forum boundary
- District/Borough boundary
- County boundary

Legend - Sound related features

- Ground-borne sound & vibration study area (residential and non-residential)
- Ground-borne sound & vibration study area (highly sensitive non-residential)
- Airborne sound assessment location
- Airborne sound and vibration assessment location
- Ground-borne sound and/or vibration assessment location
- Airborne sound, ground-borne sound and vibration assessment location
- Minor ground-borne noise or vibration impact

Legend - Earthworks

Engineering earthworks: Non engineering earthworks:

- Embankment
- Cutting
- L_{Amax} >= 60dB façade **

* Residential buildings only
* Labelled with total barrier height above rail level
** ES/SES HS2 train only L_{Amax} + 2.5dB façade correction

Map Number SV-02-050a

Map Name Operational Airborne Noise and Vibration Impacts and Likely Significant Effects (with Assessment Locations) SES1 and AP2 ES

Community Forum Area CFA18: Stoneleigh, Kenilworth & Burton Green

hs2

HS2 Ltd accept no responsibility for any circumstances, which arise from the reproduction of this map after alteration, amendment or abbreviation or if it is issued in part or issued incomplete in any way.

Registered in England. Registration number 06791686.
Registered office: One Canada Square, London, E14 5AB.

© Crown copyright and database rights 2016.
Ordnance Survey Licence Number 100049190.

Scale at A3: 1:10,000

Doc Number: C250-ARP-EV-MAP-000-001571-AP02-P01